

Proposed Project at Mouza-Balidanga, J.L. No-35, L.R. Plot No-1216, R.S. Plot No-618(P), 621(P), 621/1729(P), L.R. Khatian No-11223, 11224, R.S. Khatian No-176, at Mahalla-Baronilpur Suhrid Pally, Holding No-316, Ward No-14, under Burdwan Municipality, P.S.-Burdwan, District-Purba Bardhaman

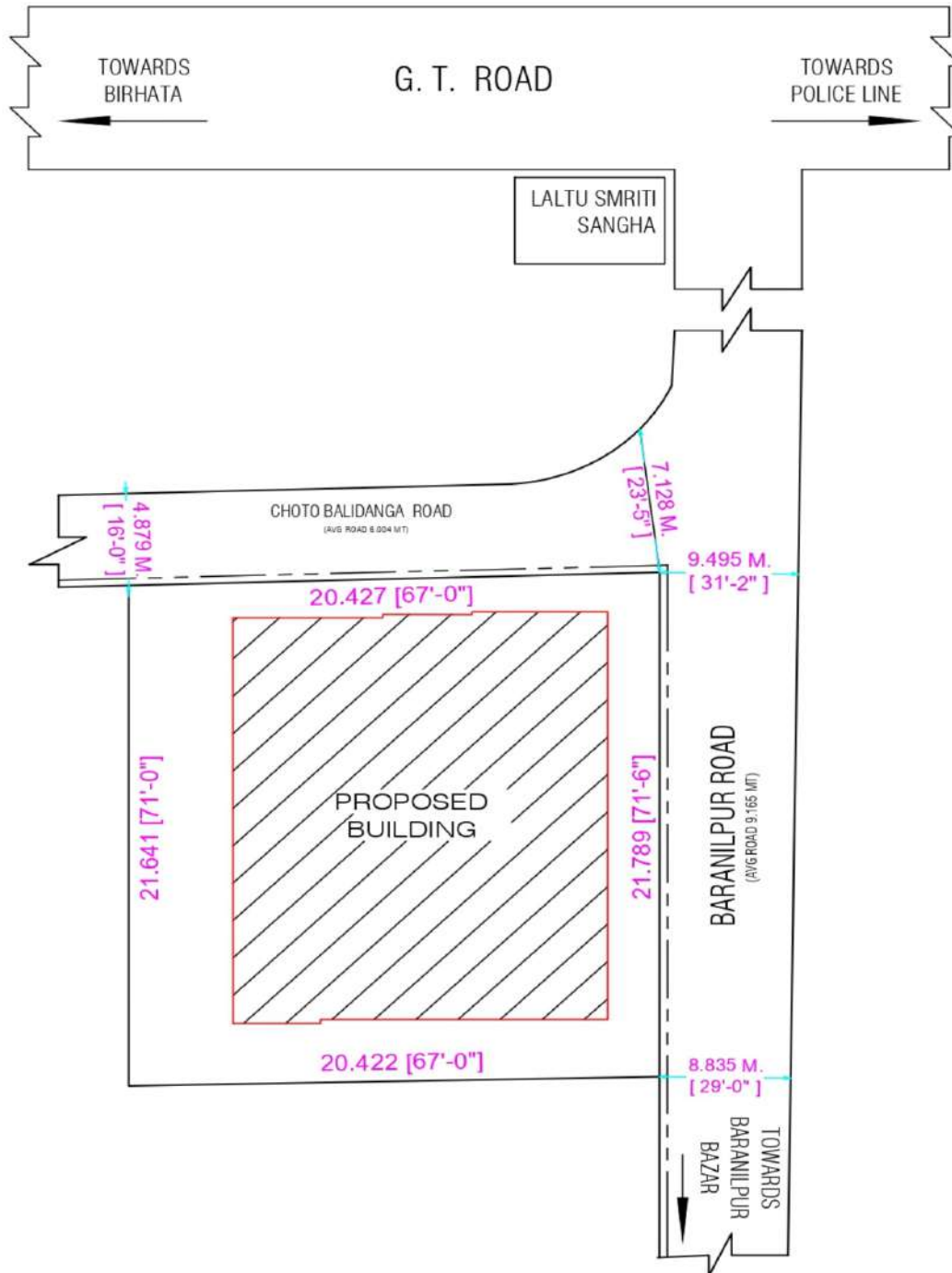

LATITUDE : 22.915760
LONGITUDE : 87.799660

Smart Homes

Aneeb Samanta
Partner

SIGNATURE OF OWNER